



GENERAL INFORMATION

Type	D3EA80M4AB35YY	Efficiency Class	IE3
Pout [kW]	0,75	Vibration Class	A
Speed [rpm]	1435	Weight [kg]	
Frame	80M	Degree of Protection	IP55
Current [A]	3,3	Cooling Method	IC 411
cos φ	0,72	Insulation Class	F
Rotation	CW-CCW	Temperature Class	B
Duty	S1	Construction	IM B35
Ambient Temp. [°C]	-20...+40	Altitude above sea [m]	1000

 		3~MOT		Type	VM 80-4			η%
		S1	IM B35	IP 55	I.C.L.F.		IE3 - 79,6	
	V	Hz	A	kW	cos φ	1 / min	LOAD	EFF.
Δ	230	50	3,3	0,75	0,72	1435	%75	80,3
Y	400	50	1,9	0,75	0,72	1435		
Y	480	60	1,9	0,9	0,71	1720	%50	77,0

ELECTRICAL DATA (RAW MEASUREMENT DATA)

V1	%Load	T [Nm]	I [A]	rpm	P2 [W]	cos φ	Efficiency	Hz
400	100	4,99	3,3	1435	750	0,72	79,6	50
400	75	3,67	1,6	1470	565	0,63	80,3	50
400	50	2,42	1,4	1480	375	0,5	77	50

Locked Rotor Current	Ia [A]	13	Breakdown Torque	Mk [Nm]	17,2
	Ia / In	3,94		Mk / Mn	3,45
Locked Rotor Torque	Ma [Nm]	17	No Load Current	[A]	1,2
	Ma / Mn	3,41	No Load Power	[W]	95

MECHANICAL DATA

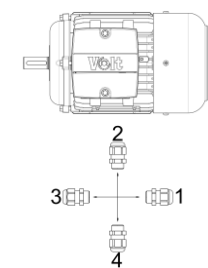
DE Bearing	6204-ZZ	Sound Pressure - 50 Hz - dB[B]	75	
NDE Bearing	6204-ZZ	Sound Pressure - 60 Hz - dB[B]	76	
Fixed Bearing	YES	Housing Material	Aluminium	
Lubrication	-	DE Shield Material	Aluminium	
Grease Amount	-	Terminal Box Material	Polyamide	
Grease Type	-	Cable Entry	PG 11	
Feather Key	6*6*32	Cable Gland Position	4	
Balance	G 1,6 Half Key			

MECHANICAL DIMENSIONS

A	AA	AB	AC	AD	B	B'	BA	BB	C	D	d	E	EB	F	GA
125	35,07	32,03	158,2	-	100	-	32,03	125,07	50	19	M6	40	32	6	21,5
GD	H	HA	HC	HD	K	K1	L	LA	LB	M	N	P	S	S1	T
6	80	14	159,5	207,5	15	10	306	10	296	165	130	200	12	4	3,5

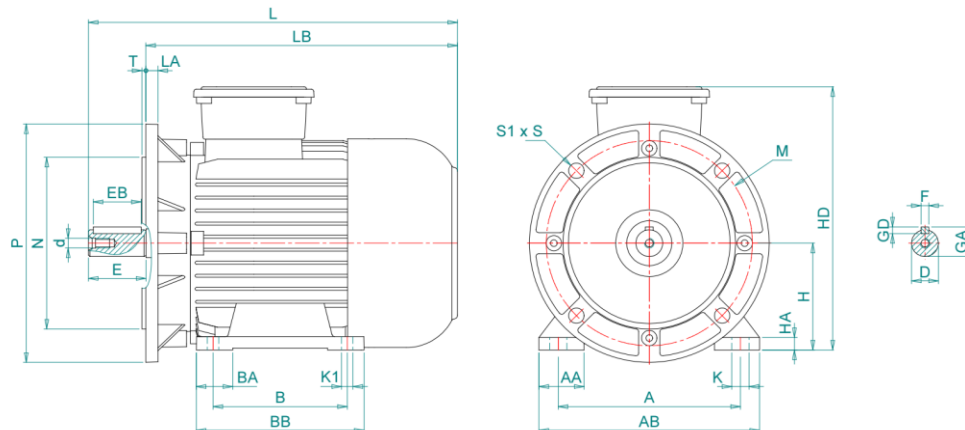

Kazim Karabekir Cad. No:84 Kemalpaşa 35735 İzmir/Turkey

Tel: +90 (232) 877 10 60 (pbx)

Fax: +90 (232) 877 10 59

Email: info@voltmotor.com.tr

www.voltmotor.com.tr

Volt Motor has right to change all the data without prior notice.